



The Weekly Weeder

A weekly publication for our CSA members
ISSUE 1: MEMBERSHIP INFORMATION - JUNE 2009

WWW.RIDGELANDHARVEST.COM

News From the Farm

IMPORTANT: PLEASE READ ATTACHED MEMBERSHIP DETAILS.

The first delivery is Wednesday, June 17th. With the cold, dry weather, we decided to set the first delivery a week later than we'd wanted. And so at long last we'll start the eating adventure. Read the "How to pick-up your box" details on the following pages.

It's been a good start to the season! We have a hard working, seasoned crew that's enabled us to get lots of things accomplished this spring. We've stayed caught up with the greenhouse work, mulching crops, planting in the field, and various other pre-season projects that you'll hear more about this spring. So far this spring we have planted around 13.5 acres of produce. Half of the crew are returning from last season and includes three full-time guys and three high school students. You'll meet them in our next newsletter (the week of June 17th).

It's been a cold, dry spring that has slowed the growing of some crops. In general, crops are smaller than they would be in a typical spring because it's been cool but mainly because of the dry conditions and cool nights. We started our irrigation lines in mid-May—the earliest ever on our farm. While we have billions of seeds planted (really!), they need moisture to germinate; and while the transplants look good, they're sitting and waiting for rain. So, there will be things coming later than we had planned—like the first broccoli. That said, our crops are looking strong and we feel optimistic about the rain in the forecast.

Pick-up Site Information: Please review the details about your pick-up site to ensure that the time, location, and details will work. If you'd like to change pick-up site locations, email or call us as soon as possible.

Communication with the Farm: We're being more paper conscious this season and using electronic methods of sharing information. Each week you'll receive an email prior to the Wednesday delivery, which will link you to the current week's newsletter and News from the Farm. Our newsletters will tell you what's in your CSA box, tips on storage and use, and recipes, and also make any announcements, event dates, and how to purchase extra produce. Our website will house the "News from the Farm", latest photos, and individually list the recipes for ease of searching.

Farm Events: We hope you'll be able to visit the farm sometime this season! While you're always welcome to visit (calling ahead so we can set aside some time with you), we have two annual farm events.

The Garlic Harvest, which occurs in late July and is a chance for members to participate in the harvest. All ages are welcome—our toddler helped last year and had fun finding worms! ***The fall Pumpkin Fest*** will likely be held in late September and will include lots of delicious food and pumpkins for everyone. The exact dates of these events are set as mother nature works her magic in maturing the crops for harvest. Details will be given in the newsletter.

Thank you for your support!

From all of us at the farm,

Mat and Cate

CSA Member Responsibilities:

- Members of the Ridgeland Harvest CSA share in the bounty as well as risks of farming. Due to weather and/or other production factors, the quantity and quality of produce you receive may be more or less than expected. If you can not finish the season as a member, for whatever reason, you may reassign your share with another household, but we do not issue refunds for shares.
- It is *your responsibility* to know when and where your share will be delivered and to pick it up within your site's open hours on delivery day. If you are unable to pickup your box, you are responsible to make alternate arrangements a head of time – have someone else pickup your box for you, ask the farm not to make a box for you, or ask the site coordinator to hold your box for you for a later pickup. The farm will not issue credit or refunds for unclaimed or forgotten boxes.
- Read the newsletters that accompany each delivery. Besides news from the farm, recipes, special offers, and invitations, we communicate important announcements through them. Newsletters will be emailed prior or on the day of delivery and are also available for download from our website: www.ridgelandharvest.com.
- Bring a box or bag with you to your site to unpack your CSA box. Then, leave the waxed box for the farm to re-use. Directions on how to disassemble the boxes are below.
- All correspondence and newsletters are sent via email. To ensure that you receive all email communications add csa@ridgelandharvest.com and rharvest@mwt.net to your list of safe addresses in your SPAM filter.

How to flatten your box:

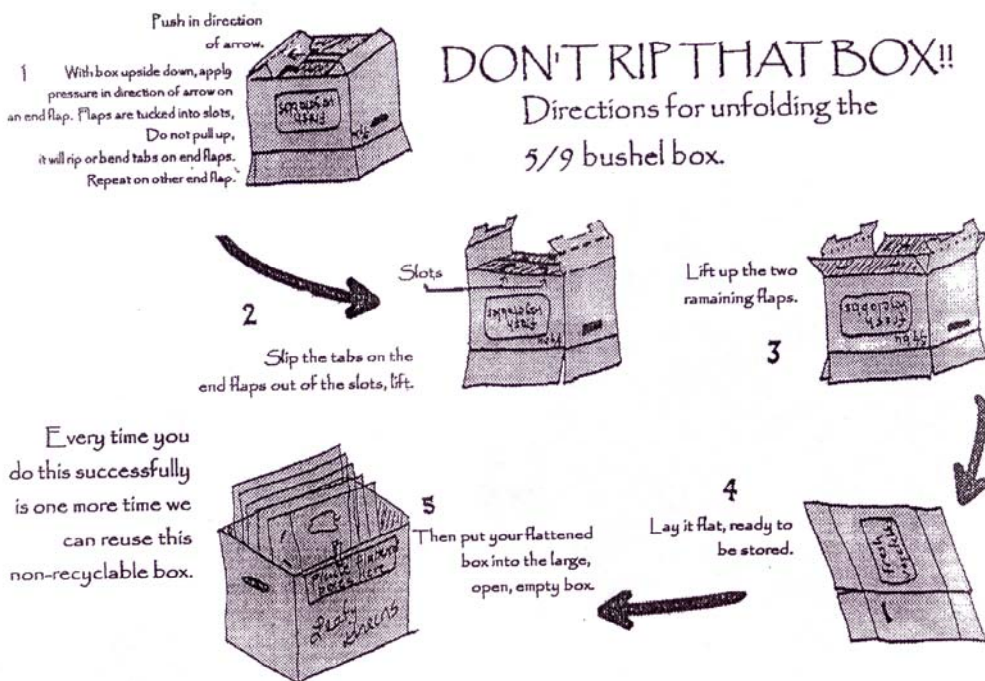

What is the SWAP BOX?

If you really don't like a particular vegetable, put it in the swap box for someone else to pick up, then take an item in exchange. While you may not like something, someone else likely will, so nothing goes to waste!

Please only take one item. Example: You put in the 3 green bell peppers, you swap for 1 bunch of beets, not 3 bunches.

Some pick-up sites don't have the swap box option.

*** How to pick-up your CSA box ***

(It should be easy, right? Yes, but only if you follow the below.)

1. Respect the rules and hours of each pick-up site

Arrive within the designated time frame. Some sites are unable to hold boxes, so you may be out of luck if you can't arrive on time.

Read, understand and follow the rules for your site. Members may switch sites at anytime provided they give the farm adequate notice.

2. Take the right box

Boxes are labeled with the names of the primary contact person of each share. Take ONLY the box with the name of the primary contact person for your share. Half Shares are packed in smaller boxes; Full Shares are packed in larger boxes. Do NOT take someone else's box until you have consulted your site coordinator.

3. Transfer the produce leave the box

Remember to bring your own bag, box or cooler. Boxes should not be taken home. We reuse boxes and need every one of them.

Leave your flattened box in the designated area at your pick-up site.

4. Don't rip that box

Boxes are expensive (average of \$1.55 each). Please be VERY GENTLE when unfolding your box (study the instructions on the previous page). Please do NOT to rip the box!

5. If you have someone else picking up your box, be sure they understand all of the above (especially #2).

Contact your site coordinator with any pick-up site questions or concerns.

Pick-up Site Details

Start times are approximate and will vary with traffic, weather and mechanical issues.

Rusk Avenue, Viroqua

Site Coordinator: Joe and Janna Lenarz

Phone: 608-637-6786

Address: 320 Rusk Avenue, Viroqua

Time: 1-8 pm. Please no calls after 8 pm.

Details: The boxes will be in the garage, in the left-hand stall. Entry should be through the left-hand garage (vehicle) door. Empty boxes and a swap box will also be set up on the left-hand side. We have young kids and try to have them in bed by 8, so please no calls or pick-ups after 8 pm. We also have dogs, and they'll probably bark if they see you. Please don't pet the dogs over the fence if they happen to be out--the black dog may nip.

People's Food Coop, La Crosse

Site Coordinator: Roger Bertch

Phone: 608-784-5798

Address: 315 5th Avenue South, La Crosse

Time: 3-10 pm

Details: Boxes will be located in the cooler of the Produce Department. You'll need to find a produce department staff person to retrieve your box. The Swap Box will likely be located in the cooler too, so you'll need to ask the employee about this if you wish to swap something. Return empty boxes to a staff person.

YMCA—La Crosse

Site Coordinator: Denise Granger

Phone: 782-9622 ext. 232

Address: 1140 Main Street, La Crosse

Time: 3-8 pm

Details: The boxes for pick up will be located next to the Member Services desk. Someone will always be available at the Member Services desk to help, but for specific questions about the CSA the site coordinator should be contacted. The empty boxes can be left in the same location, by Member Services desk at both locations. A swap box will be set up. Members need to pick up their boxes by 8:00 p.m.

YMCA—Onalaska (Y—North)

Site Coordinator: Annette Steele

Phone: 783-9622 ext. 724 or Cell 738-8808

Address: 400 Mason Street, Onalaska

Time: 3 - 8 pm

Details: The boxes for pick up will be located next to the Member Services desk. Someone will always be available at the Member Services desk to help, but for specific questions about the CSA the site coordinator should be contacted. The empty boxes can be left in the same location, by Member Services desk at both locations. We will set up a "Swap Box". Members need to pick up their boxes by 8:00 p.m.

Union Street

Site Coordinator: Irene Ong

Phone: 608-217-9959

Address: 2922 Union Street, Madison

Time: 2-9 pm. Please no calls after 9 pm.

Details: We have an enclosed front porch. Boxes will be apparent to the left as you enter the porch. Flattened boxes should be left in designated area (sign will mark where). A swap box will be set up for members to utilize.

Dunning Street

Site Coordinator: Sheila Lenius

Phone: 608-243-1193

Address: 173 Dunning Street - A white corner house with fire hydrant, one block in from Atwood.

Time: 2-8 pm. Please no calls after 9 pm.

Details: Look for the Ridgeland Harvest logo in the window of the house. Boxes will be placed on the shady porch. Park on the street and walk onto the porch. A place for empty boxes and the Swap Box will located on the porch.

Nature's Bakery

(if the window of time makes it difficult to pick up your box you may switch to another site—such as Spaight Street)

Site Coordinator: On pick-up day any staff person, otherwise contact the farm

Phone: PLEASE DO NOT CALL

Address: 1019 Williamson Street, Madison

Time: 2:30-5:30 pm (**NO OVERNIGHT BOX HOLDING and NO EXCEPTIONS TO TIME**)

Details: You will go up 2 flights of stairs to where the boxes will be located. You will pass the Bakery's retail front and production kitchen and up the second flight of stairs. Metal shelving will house boxes for pick-up and for empty boxes. **Please do not call to ask us to hold boxes**—there isn't space in our cooler. No swap box at this location. Please also be conscious to pick up any produce scraps while transferring produce from your box so the floor remains clean.

Spaight Street—Orton Co-op House

Site Coordinator: John Zinda

Phone: Orton Co-op House Phone: 608.442.0121 (call first) then John Zinda: 513.304.5566

Address: 1239 Spaight Street, Madison

Time: 2-7 pm.

Details: Boxes will be located on our front porch. We'll put up a 'place empty boxes here' sign on one side. A swap box will also be labeled for members to use.

Mandan Circle—Nakoma Neighborhood

Site Coordinator: Shelly Kennedy

Phone: 608-238-7860

Address: 4018 Mandan Circle, Madison

Time: 2-7:30 pm

Details: Boxes will be located inside the garage in the back right corner on top of a table. Please use the key pad on the outside left of the garage door to open & close it. The code will be 1234 Wednesdays only. Remember to close it as you leave. Leave flattened boxes on the space on the table on the far left side. Feel free to pull up the driveway. If you need to leave a message regarding your pick up, please use the 608-238-7860 number and let me know how I can reach you back if we are not available. I have toddlers that nap in the afternoon, so please avoid ringing the front door bell or knocking on doors unless it is urgent.

Field Street

Site Coordinators: Tracy Schumacher and Jonah West

Phone: 608-251-4168

Address: 2032 Field Street, Madison

Time: 2-8 pm

Details: The boxes for pick-up will be in the garage on a white table. Garage door will be open during pick-up hours. Empty boxes should be flattened and placed back on the white table. It is fine to park in our driveway when picking up produce, but please do not idle cars. If someone has a question they can knock on the front door anytime during the day. You can call us to hold a box, but all boxes need to be picked up by the following day.

Regent Market Coop

Site Coordinator: Produce Manager

Phone: 608-233-4329

Address: 2136 Regent Street, Madison

Time: 2-9 pm

Details: Go to the Meat/Deli case where you'll ask a staff person to get your box. Boxes are housed in their cooler. Empty boxes should be flattened and handed back to a staff person. No swap box at this location.

Fox Ave—Dudgeon-Monroe Neighborhood

Site Coordinator: Luke Zahm

Phone: 608-230-6044, mobil: 215-9240 or email lukezahm@yahoo.com, lzahm@epicsys.com

Address: 2202 Fox Avenue, Madison

Time: 2-9 pm

Details: The boxes will be located in the shed near the back of our property which is located directly on the Southwest Commuter Bike Path. Feel free to walk down the drive way, through our container garden and enter the "shed/garage" on the East side of the building. The boxes will be located on a palate and will be visible. Members should break down empty boxes and place them next to the full boxes. I will provide a swap box and a table so people can sort out their food. We have an English Bulldog named "Ancho"- he looks menacing but he is fat, lazy and nice. You might also have to navigate around our cars in the driveway. Also, there are stone cairns in the front lawn that aren't exactly stable (they would legally be categorized as an "attractive nuisance"), please use caution if you happen to bump into them. My wife also sleeps during the day so try not to ring the door bell or call before 3:00 pm.

Dolomite Lane

Site Coordinator: Rita Haft

Phone: 608-848-2943

Address: 8310 Dolomite Lane, Madison. Our home is 2 blocks in from the M & Midtown intersection.

Time: 2:30-7 pm. Please no calls after 8:30 pm.

Details: Boxes will be located in the garage. The garage door will be open and visible from the road. A counter will house the Swap Box and flattened boxes. If you have any questions or need anything, use the front doorbell instead of knocking on the garage door, so Rita's sure to hear you. There is a supply of paper bags made available for anyone that's forgotten to bring a bag or box along for produce transfer. These are kept next to the CSA shares.

Epic Systems — Verona Campus

Site Coordinator: Luke Zahm

Time: 2:30 -5 pm

Details: Boxes will be located in the cafeteria on carts. Swap Box will also be located in the cafeteria and labeled so members can easily find it. Empty boxes should be flattened and placed onto designated carts.

Epic Systems — Tokay Campus

Site Coordinator: Luke Zahm

Time: 2-5 pm

Details: Boxes will be located in the Commons Area on carts. The Swap Box will also be located in the cafeteria and labeled so members can easily find it. Empty boxes should be flattened and placed onto designated carts.

Tuvalu Coffeehouse & Gallery

Site Coordinator: Erika Hotchkiss

Address: 300 South Main Street, Verona

Phone: 608-219-0908

Time: 3 pm—close

Details: Boxes will be located inside the store. Inquire at the counter.